



Main Features

- ◆ Intel® Core™ 2 Duo/Core™ 2 Quad Platform
- ◆ S3 4300E GPU
- ◆ 4 x DVI/4 x Audio
- ◆ Dual GbE LAN
- ◆ 6 x Serial Ports
- ◆ TV Tuner/WLAN Support

Product Overview

NDiS 542 is specifically designed to address the need for application to present high quality contents on multiple displays. NDiS 542 provides four independent DVI and Audio outputs, dual GbE Ethernet with optional wireless connectivity, TV Tuner, and 3.5" HDD drive bay for storage. Powered by Intel® Core™ 2 Duo/Core™ 2 Quad series processors and S3 4500E GPU, NDiS 542 can smoothly playback multiple Full HD videos. NDiS 542 is an advanced media player for any applications to demonstrate high quality and high impact contents over multiple displays.

Specifications

CPU Support

- ◆ Intel® Core™ 2 Duo/Core™ 2 Quad series processor

Chipset

- ◆ Intel® P45+ICH10
- ◆ S3 4300E GPU

Main Memory

- ◆ 2 x 240-pin DIMM sockets, support DDR3 1066MHz SDRAM memory module up to 4GB

I/O Interface-Front

- ◆ 4 x DVI-I
- ◆ 4 x Audio line-out
- ◆ 2 x RJ45 with LEDs for 10/100/1000Mbps Ethernet
- ◆ 1 x DB9 for RS-232
- ◆ 1 x terminal block for 4 serial ports
- ◆ 4 x USB
- ◆ 1 x Power switch
- ◆ 2 x Antenna hole for Wi-Fi and TV tuner

I/O Interface-Rear

- ◆ 1 x DB9 for RS-232
- ◆ AC power inlet

Storage Device

- ◆ 1 x SATA 3.5" HDD

Expansion

- ◆ 1 x Mini-PCIe socket for optional WLAN module
- ◆ 1 x Mini-PCIe socket for optional TV tuner module

Dimensions

- ◆ 426.2mm (W) x 365mm (D) x 44mm (H)
(16.8" x 14.4" x 1.7") w/o rubber stand

Power Supply

- ◆ Input: 100~240VAC

Environment

- ◆ Operating Temperature: Ambient with air flow from 0 to 40°C
- ◆ Storage Temperature: -20 to 80°C
- ◆ Humidity: 10 to 90% (Non-condensing)

Dimension Drawing

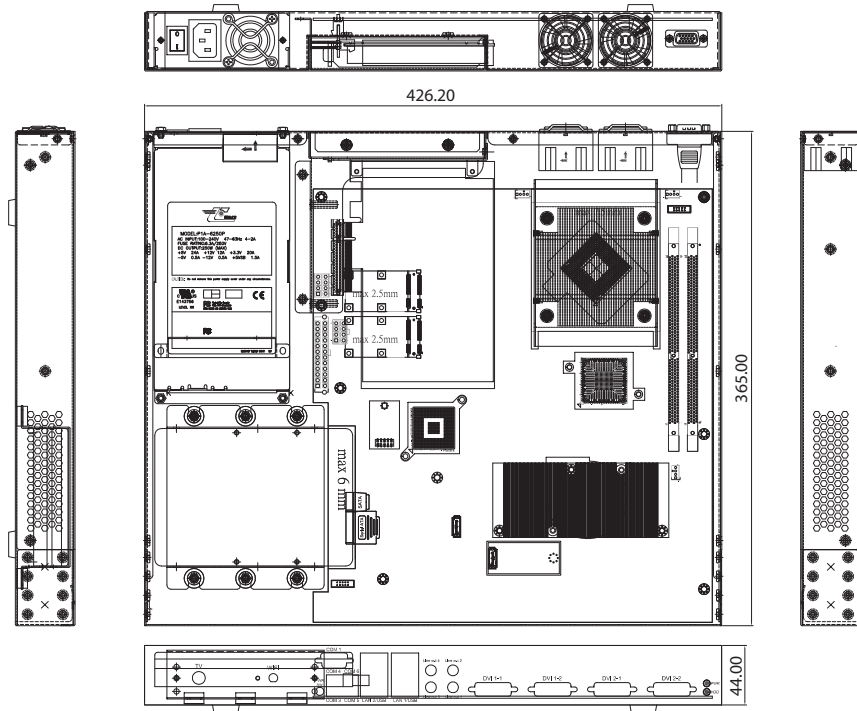

Certification

- CE approval
- FCC Class A

Ordering Information

- **NDiS 542 (P/N: 10W00054200X0)**
Intel® Core™ 2 Duo/Core™ 2 Quad family processor
Intel® P45/ICH10 chipset